

Mapping Asian Bears

Signing People Up

Admin Page

1. Click the “Admin” in the top-right menu bar to enter the Admin Page.

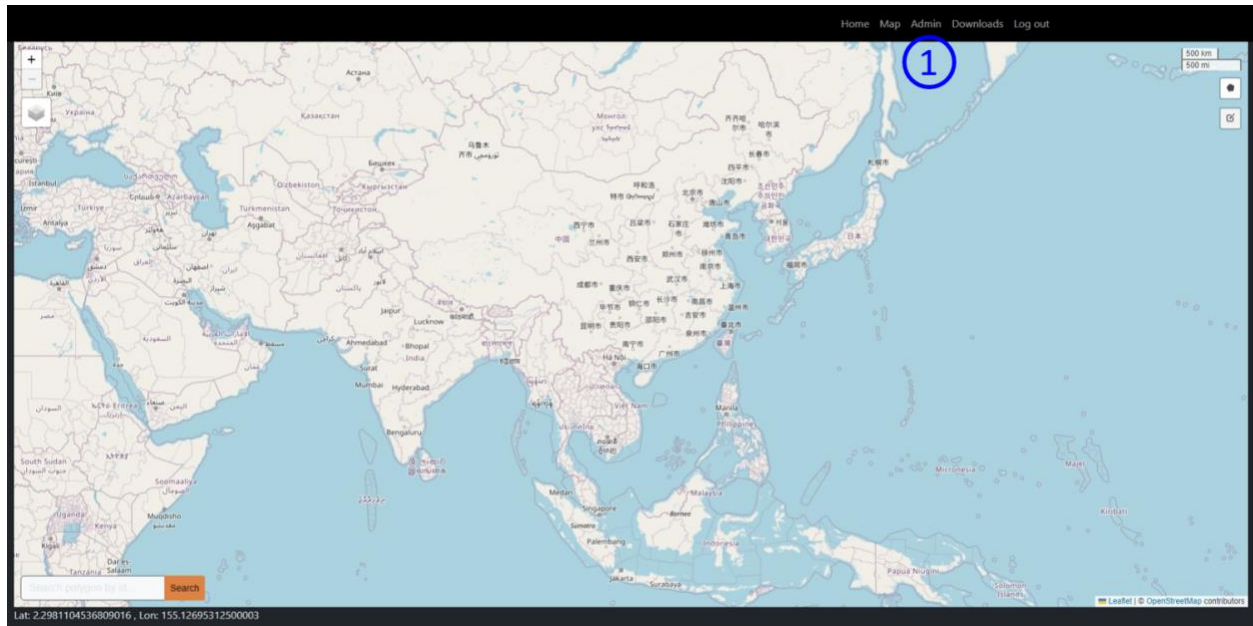

2. Click the orange “+” button in bottom-right to get into the “Create user” step.

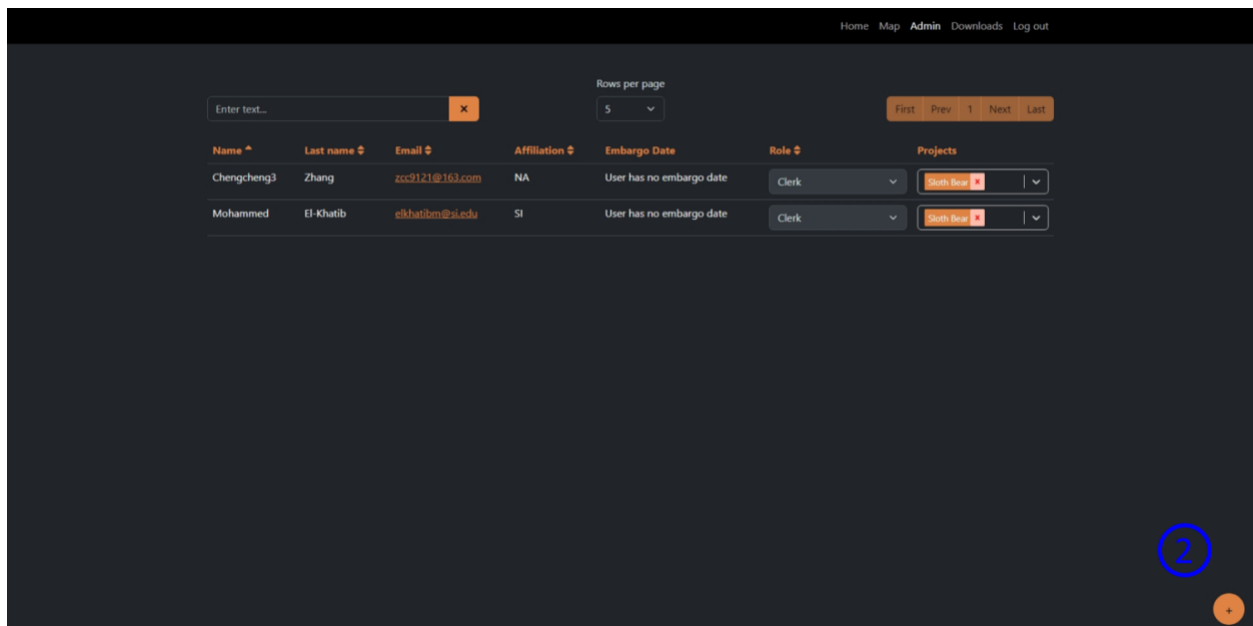

3. In the “Create user” pop-up window, fill in name, email address, and affiliation to sign people up. Each field is required. Fill in “NA” if affiliation is not known.
4. After the information is filled in, click the orange “Create” button, an invitation email will be sent to the person.

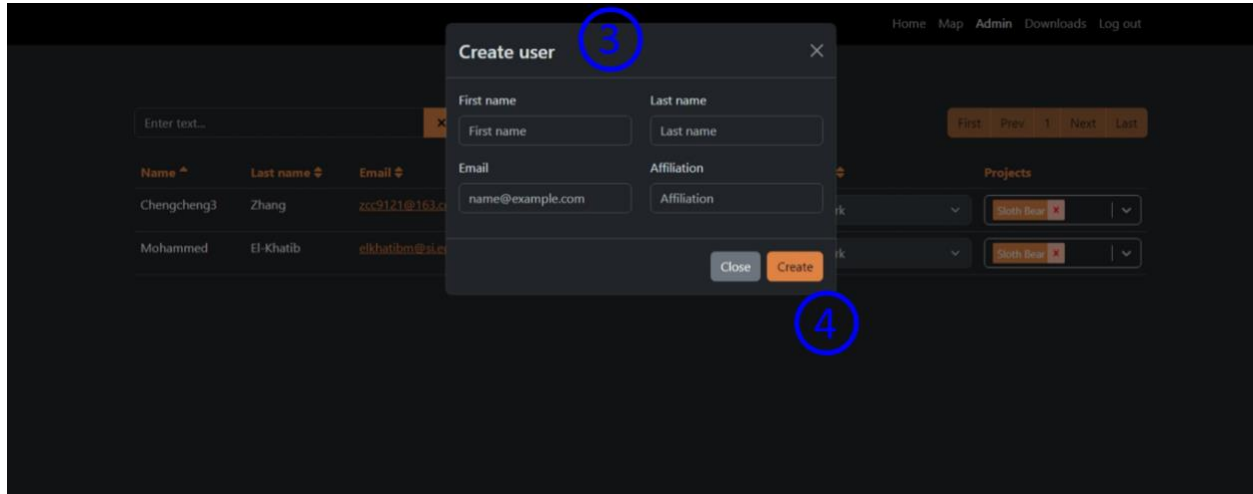

5. Once the user is created, you must go back and register them for a bear species, using the dropdown menu. (If you do not do this, they will not be able to map that species.) Please contact Chengcheng Zhang (ZhangC@si.edu) if you know about people with expertise in 2 or 3 bear species.

